

HIEMAN TAILGATES, INC. KIT 131 CAB SHUT-OFF SWITCH

ENGINE COMPARTMENT

CONTINUOUS DUTY SOLENOID'S
CYLINDRICAL BODY AXIS
MUST RUN HORIZONTALLY

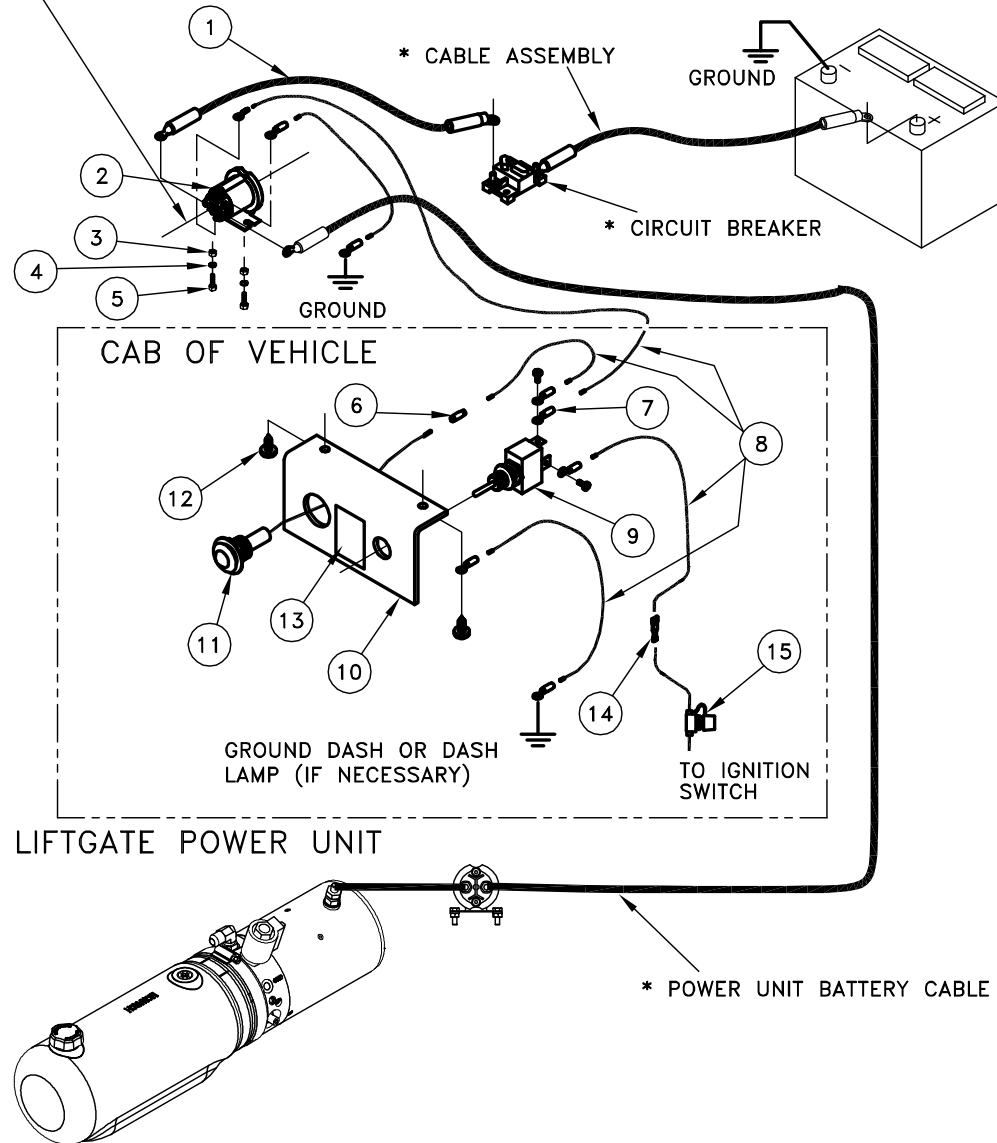

* DENOTES PARTS WHICH ARE INCLUDED WITH THE STANDARD LIFTGATE AND NOT THE 131KIT.



600 East Wayne Street Celina, Ohio 45822 Phone:(419)586-7727 Fax:(419)586-9724

ITEM	PART NO.	DESCRIPTION	QTY.
1	4318-001	2 FT. CABLE ASM.	1
2	4478	CONT. DUTY SOLENOID	1
3	8120375	NUT, 1/4	2
4	8120380	LOCKWASHER, 1/4	2
5	8180022	SCREW, 1/4 X 1	2
6	4300-004	BUTT CONNECTOR	1
7	4300-009	RING TERMINAL	8
8	4386-002	12GA. WIRE, 10 FT.	1
9	4300300	TOGGLE SWITCH	1
10	2711040	BRACKET	1
11	4300290	DASH LAMP	1
12	5701140	SHEET METAL SCREW	2
13	4670	LIFTGATE POWER DECAL	1
14	4300-030	STEP DOWN BUTT CONNECTOR	1
15	43039	FUSE HOLDER/20A FUSE	1

* DENOTES PARTS WHICH ARE INCLUDED IN THE STANDARD INSTALLATION KITS AND NOT THE 131 KIT.

KIT INSTALLATION INSTRUCTIONS

1. COMPLETELY INSTALL THE LIFTGATE AS OUTLINED IN THE INSTALLATION INSTRUCTIONS.
2. BEFORE BEGINNING THE 131 KIT INSTALLATION, MAKE SURE THE GATE IS WORKING PROPERLY IN ALL PHASES OF OPERATION. (THIS WILL RULE OUT A PROBLEM WITH THE LIFTGATE IF PROBLEMS OCCUR.)
3. UNHOOK THE POWER UNIT BATTERY CABLE FROM THE CIRCUIT BREAKER.
4. MOUNT THE CONTINUOUS DUTY SOLENOID WITHIN 2 FT. OF THE CIRCUIT BREAKER IN THE ENGINE COMPARTMENT USING THE HARDWARE SUPPLIED. USE A 12GA. JUMPER TO GROUND ONE OF THE SMALL TERMINALS ON THE SOLENOID AS SHOWN. (NOTE: AXIS OF CYLINDRICAL SOLENOID BODY MUST RUN HORIZONTALLY).
5. CONNECT THE CONT. DUTY SOLENOID TO THE CIRCUIT BREAKER USING THE 2 FT. CABLE ASM. PROVIDED.
6. CONNECT THE POWER UNIT BATTERY CABLE TO THE OTHER LARGE POST ON THE CONT. DUTY SOLENOID.
7. MOUNT THE BRACKET IN A CONVENIENT LOCATION IN THE CAB USING THE TWO SHEET METAL SCREWS PROVIDED. IF THE BRACKET IS NOT GROUNDED PROPERLY AFTER MOUNTING, A SMALL GROUND STRAP SHOULD BE MADE USING A SECTION OF THE 12 GA. WIRE AND A COUPLE OF RING TERMINALS.
8. ATTACH THE DASH LAMP, TOGGLE SWITCH, AND DECAL TO THE BRACKET.
9. CONNECT THE DASH LAMP AND CONT. DUTY SOLENOID TO THE TOGGLE SWITCH AS SHOWN USING APPROPRIATE SECTIONS OF THE 12 GA. WIRE AND THE TERMINALS AND CONNECTOR PROVIDED.
10. CONNECT THE TOGGLE SWITCH TO THE IGNITION SWITCH SO THAT THE TOGGLE SWITCH HAS POWER ONLY WHEN THE IGNITION IS TURNED ON. CONNECT THE SUPPLIED 20A FUSE AND HOLDER AS CLOSE TO THE IGNITION POWER SOURCE AS POSSIBLE SO WIRING OF THIS KIT IS PROTECTED. USE THE REMAINDER OF THE 12 GA. WIRE, STEP DOWN BUTT CONNECTOR AND TERMINALS TO DO SO.

THIEMAN TAILGATES, INC. KIT 131 CAB SHUT-OFF SWITCH

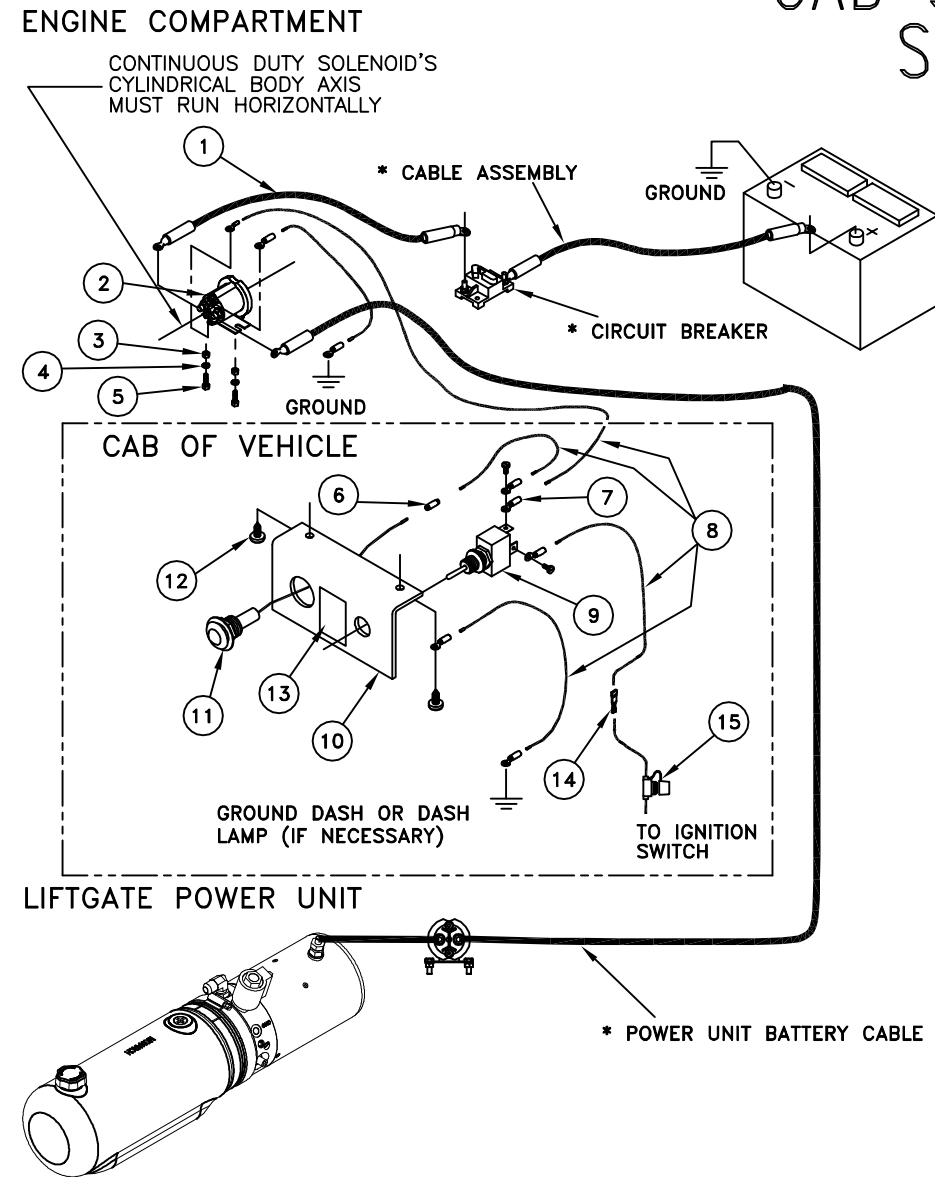

ITEM	PART NO.	DESCRIPTION	QTY.
1	4318-001	2 FT. CABLE ASM.	1
2	4478	CONT. DUTY SOLENOID	1
3	8120375	NUT, 1/4	2
4	8120380	LOCKWASHER, 1/4	2
5	8180022	SCREW, 1/4 X 1	2
6	4300-004	BUTT CONNECTOR	1
7	4300-009	RING TERMINAL	8
8	4386-002	12GA. WIRE, 10 FT.	1
9	4300300	TOGGLE SWITCH	1
10	2711040	BRACKET	1
11	4300290	DASH LAMP	1
12	5701140	SHEET METAL SCREW	2
13	4670	LIFTGATE POWER DECAL	1
14	4300-030	STEP DOWN BUTT CONNECTOR	1
15	43039	FUSE HOLDER/20A FUSE	1

* DENOTES PARTS WHICH ARE INCLUDED IN THE STANDARD INSTALLATION KITS AND NOT THE 131 KIT.

KIT INSTALLATION INSTRUCTIONS

1. COMPLETELY INSTALL THE LIFTGATE AS OUTLINED IN THE INSTALLATION INSTRUCTIONS.
2. BEFORE BEGINNING THE 131 KIT INSTALLATION, MAKE SURE THE GATE IS WORKING PROPERLY IN ALL PHASES OF OPERATION. (THIS WILL RULE OUT A PROBLEM WITH THE LIFTGATE IF PROBLEMS OCCUR.)
3. UNHOOK THE POWER UNIT BATTERY CABLE FROM THE CIRCUIT BREAKER.
4. MOUNT THE CONTINUOUS DUTY SOLENOID WITHIN 2 FT. OF THE CIRCUIT BREAKER IN THE ENGINE COMPARTMENT USING THE HARDWARE SUPPLIED. USE A 12GA. JUMPER TO GROUND ONE OF THE SMALL TERMINALS ON THE SOLENOID AS SHOWN. (NOTE: AXIS OF CYLINDRICAL SOLENOID BODY MUST RUN HORIZONTALLY).
5. CONNECT THE CONT. DUTY SOLENOID TO THE CIRCUIT BREAKER USING THE 2 FT. CABLE ASM. PROVIDED.
6. CONNECT THE POWER UNIT BATTERY CABLE TO THE OTHER LARGE POST ON THE CONT. DUTY SOLENOID.
7. MOUNT THE BRACKET IN A CONVENIENT LOCATION IN THE CAB USING THE TWO SHEET METAL SCREWS PROVIDED. IF THE BRACKET IS NOT GROUNDED PROPERLY AFTER MOUNTING, A SMALL GROUND STRAP SHOULD BE MADE USING A SECTION OF THE 12 GA. WIRE AND A COUPLE OF RING TERMINALS.
8. ATTACH THE DASH LAMP, TOGGLE SWITCH, AND DECAL TO THE BRACKET.
9. CONNECT THE DASH LAMP AND CONT. DUTY SOLENOID TO THE TOGGLE SWITCH AS SHOWN USING APPROPRIATE SECTIONS OF THE 12 GA. WIRE AND THE TERMINALS AND CONNECTOR PROVIDED.
10. CONNECT THE TOGGLE SWITCH TO THE IGNITION SWITCH SO THAT THE TOGGLE SWITCH HAS POWER ONLY WHEN THE IGNITION IS TURNED ON. CONNECT THE SUPPLIED 20A FUSE AND HOLDER AS CLOSE TO THE IGNITION POWER SOURCE AS POSSIBLE SO WIRING OF THIS KIT IS PROTECTED. USE THE REMAINDER OF THE 12 GA. WIRE, STEP DOWN BUTT CONNECTOR AND TERMINALS TO DO SO.

